

MODEL	DOLLINGER PART #	A	B	C	D	D	NOTES
DM1724-00-C	95-276, 3507610	24-1/8	16-3/8	12-13/16	25-3/4	25-3/4	CLOSED (1) END
DM1212-00-C	95-155	11-3/4	11-1/2	8-1/8	12-3/4	12-3/4	(A1)
DM1222-00-C	95-154, 3507602	21-5/8	11-1/2	8-1/8	22-5/8	22-5/8	RDC14001
DM2136-00-CEP	95-255	35-1/8	21	17	36-1/8	36-1/8	EPDM "O" -RINGS
DM2136-00-C	95-137, 3001866, 3507605	35-1/8	21	17	36-1/8	36-1/8	(A1)
DM2122-00-C	95-151	21-1/2	21	17	22-1/2	22-1/2	(A1)
DM1228-00-C	95-121, 3001849, 3507603	27-5/8	11-1/2	8-1/8	28-5/8	28-5/8	(A1)
DM1110-00-C	95-117	9	10-3/4	7-3/4	10	10	(2) ELEMENTS PER LM6000 VME
DM1120-00-C	3001786	19-1/4	10-3/4	7-1/2	20-1/4	20-1/4	(A1)
DM2124-00-C	95-115	23-1/2	21	17	24-1/2	24-1/2	(A1)
DM1236-00-C		35-5/8	11-1/2	8-1/8	36-5/8	36-5/8	
DM1212-00-CVSSS		11-3/4	11-1/2	8-1/8	12-3/4	12-3/4	
DM1222-00-C1		21-5/8	11-1/2	8-1/8	22-1/8	22-1/8	CLOSED (1) END
DM1436-00-C	3508094, 3507327	*35	13 1/2	10	*35 1/2	35 1/2	CLOSED (1) END; *WITHOUT HANDLE
DM1617-00-C	3001476	16 7/8	15 1/2	13 7/8	17 7/8	17 7/8	
DM1325-00-CSS	7421767	24	13 1/4	10	25	25	ALL STAINLESS STEEL COMPONENTS GASKET PART NUMBER 7422053
DM1325-00-C		24	13 1/4	10	25	25	ALL CARBON STEEL PLATED COMPONENTS ALTERNATE FOR DM1325-00-CSS

PHYSICAL CHARACTERISTICS:
 1- CORROSION RESISTANT END CAPS & SUPPORT STRUCTURE.
 2- POLYURETHANE FOAM GASKET(S).
 3- PLEATED FIBERGLASS MEDIA PROVIDES PARTICULATE REMOVAL AS WELL AS COALESCING CAPABILITY.
 4- ADDITIONAL OUTER WRAP OF COALESCING MATERIAL & SCREEN (DEPENDS ON SPECIFIC PART NUMBER)
 5- 260°F MAX. TEMPERATURE
 6- 99.97% EFFICIENT @ 0.3 MICRON AND LARGER

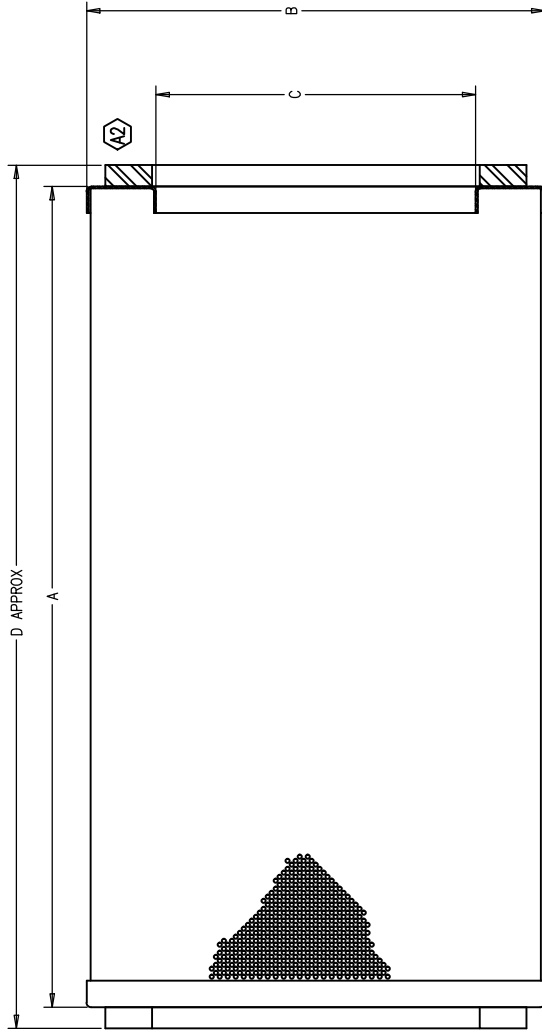

A2 WAS O-RING TO DIM INCREASED BY 1/4"	18/20 LTH
A1 ENR 05-20070106	BY DATE APP
LTR	DESCRIPTION
REVISIONS	

DRAWING STATUS		DRAWING STATUS	
DRWN	DMS	DRWN	DMS
11/09/02	11/09/02	11/09/02	11/09/02
CHEK	LTH	CHEK	LTH
11/09/02	11/09/02	11/09/02	11/09/02
APPR	LTH	APPR	LTH
11/09/02	11/09/02	11/09/02	11/09/02
SIMILAR TO:		SCALE: 1/2	

THE INFORMATION AND DATA CONTAINED HEREIN CONFORMS TO ASME Y14.5-M 1994

THIS DOCUMENT CONTAINS PROPRIETARY INFORMATION AND TRADE SECRETS OF THE ILLINOIS TOOL WORKS COMPANY. PERMISSION IS GRANTED TO REPRODUCE THIS DOCUMENT FOR THE ILLINOIS TOOL WORKS COMPANY. ALL RIGHTS RESERVED.

DATE FROM

PRODUCTION

TITLE: DOLLINGER REPLACEMENT ELEMENTS

SHEET 1 OF 1

DD-702-6